

# HEAVY DUTY AGM DUAL PURPOSE BATTERY

LPM12-210HD (12V210Ah)



## CHARACTERISTICS

Item	Specifications
Nominal Voltage	12V
Nominal Capacity (20HR)	210Ah
Reserve Capacity	450min
Cold Cranking Amps@0°F (-18°C)	1200A
Dimension	Length
	518mm (20.4inches)
	Width
Height	274mm (10.8inches)
	235mm (9.25inches)
Approx Weight	61.8kg (136.2lbs)
Terminal	5
Cell layout	3
Hold-Down	B0
Case	Black-PP Material
Cover	Black-PP Material
Handle	TS8

## APPLICATIONS

- Parking air-conditioner
- Commercial vehicle start
- Engine start

## GENERAL FEATURES

- Superior deep cycle performance
- Excellent start ability
- Super capacity reach 330Ah
- VRLA and maintenance-free design
- Excellent vibration resistance – EN V4
- High charge acceptance, fast recharge
- OE quality certification

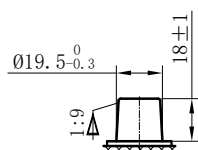

POS

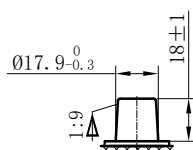

NEG

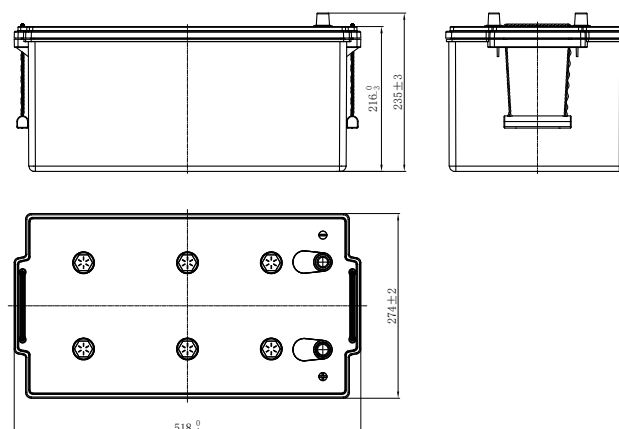

\*Values are subject to variation of +/- 5% in normal manufacturing processes.

Leoch International Technology Ltd.  
www.leoch.com

Leoch Batteries Pte Ltd  
www.leoch.sg

Leoch Battery Corporation  
www.leochamericas.com

Leoch Europe S.A.  
www.leoch.eu